

The Yashar Family

Welcome to the Yashar Mains Scope Vardi track accent light, for use with our Mains track. The accent light, a derivative of the Scope Vardi Monopoint, is the smallest head in our track offering, featuring integral drivers mounted in the track adaptor. Available driver types include 0-10 volt, DALI and phase dimming options. Sources include static white LEDs in a variety of color temperatures, as well as our proprietary Ambient Dim chips. In addition, all of the finish options available in the Vardi Monopoint are available in the Yashar version.

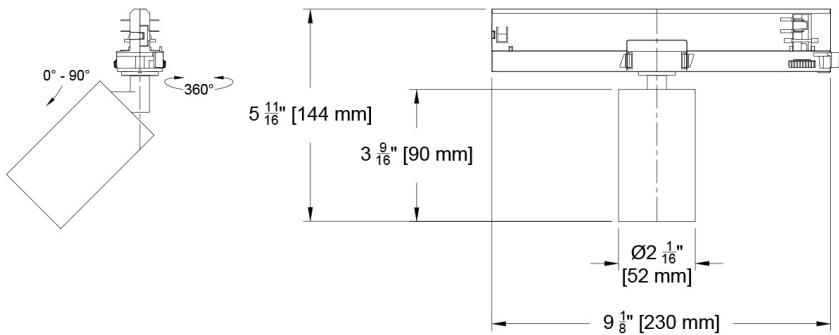

PROJECT: TYPE:
SPECIFIER: DATE:

Key Points (YSMH-SCV)

Housing

- Track accent head for use in Yashar Mains Track.
- Adjustable 360° degree rotation and 90° degree tilt.
- 40 finish options, including anodized, brass, painted + Custom/RAL#.
- Precision CNC machined aluminum in New Jersey
- Track mounted with integral drivers in track adaptor fitting.

Source / Optics

- 2 beam spreads - 15° and 30°
- Up to 748 delivered lumens
- <2 MacAdams Ellipses (<2 SDCM) for fixed white
- 2400K, 2700K, 3000K, 3500K, 4000K
Ambient Dim 1900K - 3000K
RGBWW 1800K - 8000K
- 90+ CRI, 60+ R9 Standard, 95+ CRI, 90+ R9 available with Ambient Dim option
- **TITLE 24** Supports CA Title 24 part 6 Requirements to JA8
- Lifetime: L87B3>55,000 hours at 40°C Ambient

Driver And Control

- 120 volt.
- 0-10 volt, phase and DALI. DALI control enables individual control of each fixture.
- For track mount heads, 0-10 volt dimming control provides single zone of dimming control on 120 volt (2 or 3 circuit track) as the circuits are combined on the 0-10 volt control side. For two circuit applications ELV/Triac drivers are available to dim each circuit separately as there is a separate neutral for each circuit. We do not recommend using the ELV/Triac drivers in three circuit applications, as the three circuits share a common neutral. Refer to YSMT cutsheets for details on voltage and circuiting.

Finish Options - See finish guide for full spectrum of colors

PXX- Powder Coat Paint examples



W White Paint

P13 Moog Bronze

AXX- Anodize finish examples

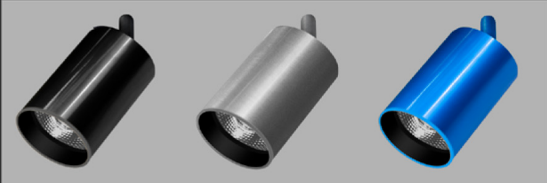

A01 Black Anod.

A32 Clear

A20 Blue

AMXX- Matte Anodize



AM32 Clear

BXX- Brass finish



B05 Satin Brass

| Beamspreads | | 15° | | | | | 30° | | | | |
|----------------|------------------|-----------------------|--------------|-----|---------|-----------|-----------------------|--------------|-----|---------|-----------|
| | System watts (W) | Delivered Lumens (lm) | Lumens/ Watt | UGR | Peak CD | 10% Field | Delivered Lumens (lm) | Lumens/ Watt | UGR | Peak CD | 10% Field |
| Citizen C5 | 6 | 462 | 77 | 6 | 4939 | 29° | 464 | 76 | 8 | 1549 | 49° |
| Citizen C9 | 9 | 707 | 79 | 10 | 6374 | 32° | 748 | 84 | 10 | 2500 | 50° |
| Ambient Dim A5 | 6 | 311 | 52 | 8 | 2829 | 31° | 315 | 52 | 6 | 985 | 50° |
| Ambient Dim A9 | 10 | 599 | 59 | 9 | 3633 | 40° | 609 | 60 | 9 | 2051 | 50° |

Ordering Codes

PROJECT: SPECIFIER:
DATE: TYPE: QUANTITY:

Ordering Code Example: YSMH-SCV-C9-27-15-TD3-AM01-91L/97L

| FIXTURE | SOURCE / WATTS | CCT | BEAM | DRIVER / CONTROL | HEAD FINISH | ACCESSORIES |
|-------------------------------------|--|---|---|--|--|---|
| YSMH-SCV | | | | | | |
| Yashar Mains Scope Vardi Track Head | <div>Citizen</div> <div>C5 6W 484Lm* 90+CRI, 60+R9</div> <div>C9 10W 748Lm* 90+CRI, 60+R9</div> <div>Ambient Dim™</div> <div>A5 6W 314Lm* 95+CRI, 90+R9 3000k to 1900k</div> <div>A9 10W 609Lm* 95+CRI, 90+R9 3000 to 1900k</div> <div>Tunable</div> <div>RGBWW 90+CRI, 60+R9 *E4 Only</div> <div>Supports CA Title 24 part 6 compliance to JA8 requirements</div> <div>*Based on 30° Beam</div> | <div>24 2400K</div> <div>27 2700K</div> <div>30 3000K</div> <div>35 3500K</div> <div>40 4000K</div> <div>Ambient Dim™</div> <div>3019 3000-1900K</div> <div>Tunable</div> <div>R1880 1800-6500K RGBWW Dynamic Color Changing *E4 Only</div> | <div>15 Spot</div> <div>30 Narrow Flood</div> | <div>TD1 0-10V 2.0%, (120-277V) linear</div> <div>TD2 DALI-2 1.0%, (120-277V) linear</div> <div>TD3 ELV/Triac 5.0%, (120-120V) linear</div> <div>E4^ DMX 0.1%, UNV (120-277V) Universal DMX Driver/Controller RGBW-DMX ^ INCLUDES DMX/RDM COMPATIBLE DRIVER WITH BUILT-IN DECODER - CONTROLLER BY OTHERS</div> | <div>AM01 Black Matte Anodize^</div> <div>AMXX Specialty Matte Anodize Color^A</div> <div>AM1-AM36</div> <div>A32 Clear Anodize^</div> <div>AXX Specialty Anodize Color^A</div> <div>A1-A36</div> <div>W White Paint^</div> <div>PXX Specialty Paint Color*</div> <div>P01-P15</div> <div>B05 Satin Brass^</div> <div>BXX Brass Finishes*^</div> <div>B01-B07</div> <div>Note: Track adaptor furnished in White with W finish head. Other finishes furnished with a black track adaptor unless otherwise specified.</div> <div>^Stem comes in selected color</div> <div>* See Finish Guide</div> | <div>Reflector (lamp) Media</div> <div>91L Solite*</div> <div>97L Black Hexcel Louver*</div> <div>XXL Other Reflector (lamp) Media*</div> <div>Other</div> <div>STM Standard length 3/8" For custom size, indicate in inches</div> <div>LENS ACCESSORY VISUAL GUIDE LINK</div> <div>FINISH GUIDE LINK</div> |

Dimensions

Yashar Mains Scope Vardi Track Head

Standard Mount

(YSMH-SCV-)

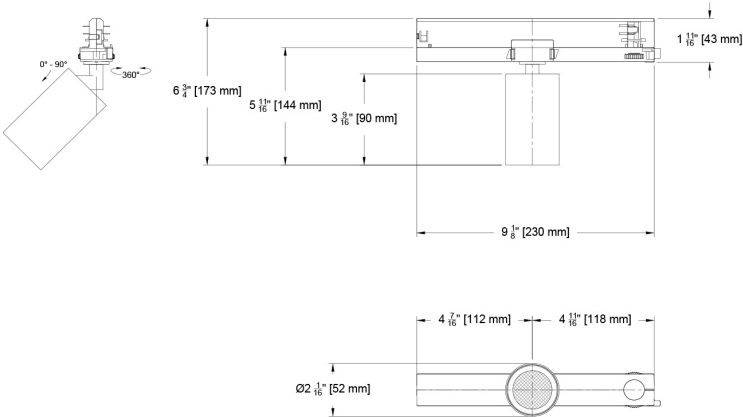

Photometric Table All data below are delivered lumens based on goniometer measurements of production representative product. All lumen values can vary +/- 10% from LED manufacturer rated nominal flux.

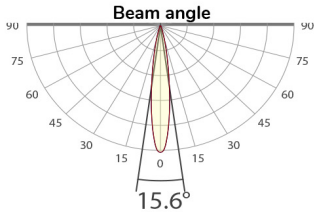
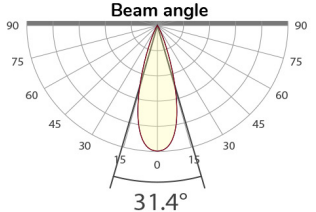
| Beamspreads | | 15° | | | | | 30° | | | | |
|----------------|------------------|---|--------------|-----|---------|-----------|---|--------------|-----|---------|-----------|
| | System watts (W) | Delivered Lumens (lm) | Lumens/ Watt | UGR | Peak CD | 10% Field | Delivered Lumens (lm) | Lumens/ Watt | UGR | Peak CD | 10% Field |
| Citizen C5 | 6 | 462 | 77 | 6 | 4939 | 29° | 464 | 76 | 8 | 1549 | 49° |
| Citizen C9 | 9 | 707 | 79 | 10 | 6374 | 32° | 748 | 84 | 10 | 2500 | 50° |
| Ambient Dim A5 | 6 | 311 | 52 | 8 | 2829 | 31° | 315 | 52 | 6 | 985 | 50° |
| Ambient Dim A9 | 10 | 599 | 59 | 9 | 3633 | 40° | 609 | 60 | 9 | 2051 | 50° |
| CCT Multiplier | |  | | | | |  | | | | |
| CCT | Citizen | | | | | | | | | | |
| 2700 | 0.95 | | | | | | | | | | |
| 3000 | 1.00 | | | | | | | | | | |
| 3500 | 1.02 | | | | | | | | | | |
| 4000 | 1.03 | | | | | | | | | | |

Color Data

All data below are delivered lumens. Color and flux information based on goniometer measurements of production representative product. All values can vary +/- 10% from LED manufacturer data range as listed on their datasheet.

Citizen Source C5, C9

- <2 MacAdam Ellipse (<2 SDCM)
- 90+ CRI and RF
- 60+R9, Hue Bin 1

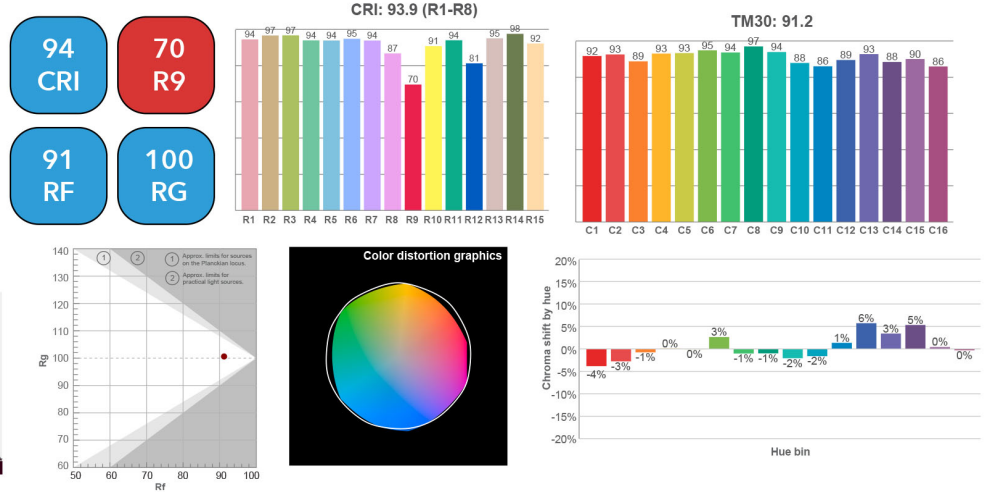

Ambient Dim Source - A5, A9 (AD - 3000k to 1900k)

- <3 MacAdam Ellipse (<3 SDCM)
- 95+ CRI and RF
- 90+R9, Hue Bin 1
- Follows Black Body Locus through dimming range

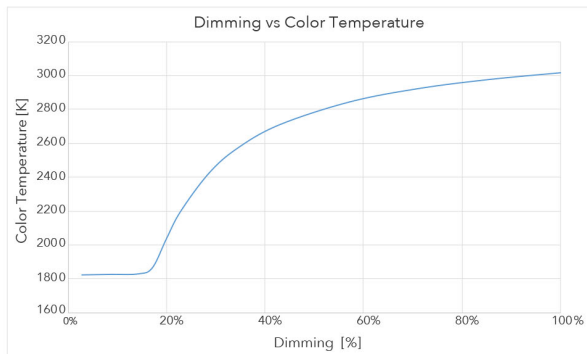

3000 CCT Full Output

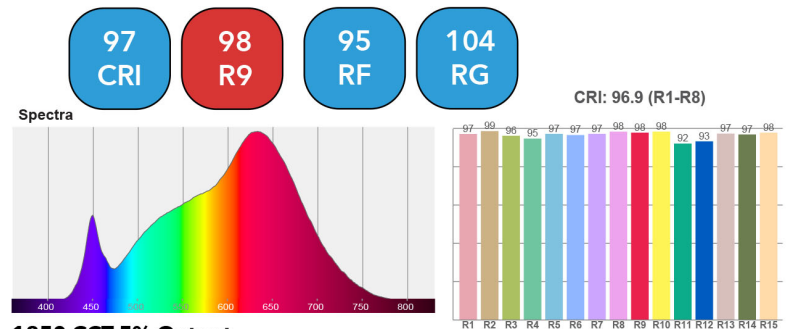

1850 CCT 5% Output

